



FEATURES

- Walk-in Storage
- Locking Storage
- Free-Standing Counter
- Semi-Private Meeting Area
- Theatre Presentation Area
- Contains Lighting Solutions

CASING

- 1 Super Tub
- 650 kgs packed weight per case
- 5 Large Plywood Case
- 150 kgs packed weight per case

PLAN VIEW

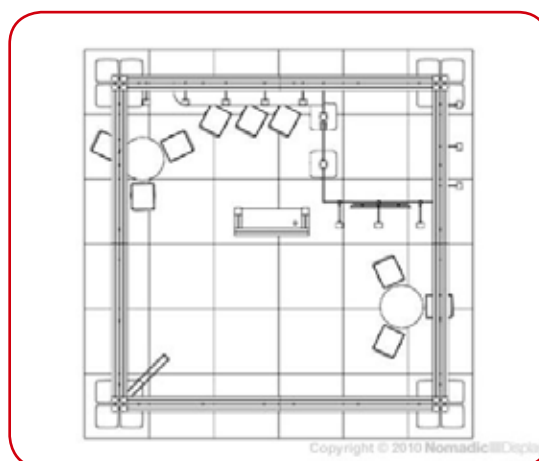



FEATURES

- Integrated A/W Workstation
- Semi-Private Meeting Area
- Free-standing Counter
- Walk-in Storage
- Product Display
- Area for Large Format Graphics

CASING

8 Flatpack 300 Cases

- 45kgs packed weight per case

1 Large Plywood Case

- 150kgs packed weight per case

PLAN VIEW

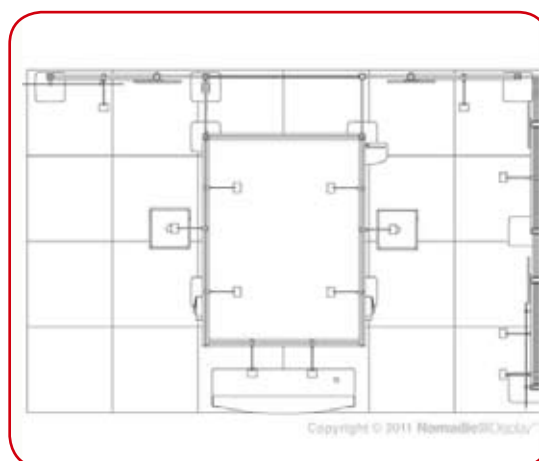

Copyright © 2011 NomadicDisplay



FEATURES

- Area for Large Format Graphics
- Free-Standing Counter
- Locking Storage
- Contains Lighting Solutions
- Brochure Holder

CASING

2 Large PanelCase

- 65kgs packed weight per case

PLAN VIEW





FEATURES

- Overhead Messaging
- Literature/Product Display
- Open Seating Area
- Free-Standing Counters
- Bar Counter
- Walk-in Storage

CASING

- 1 Flatpack 300 Case
- 45kgs packed weight per case
- 1 Super Tub Case
- 650kgs packed weight per case

PLAN VIEW

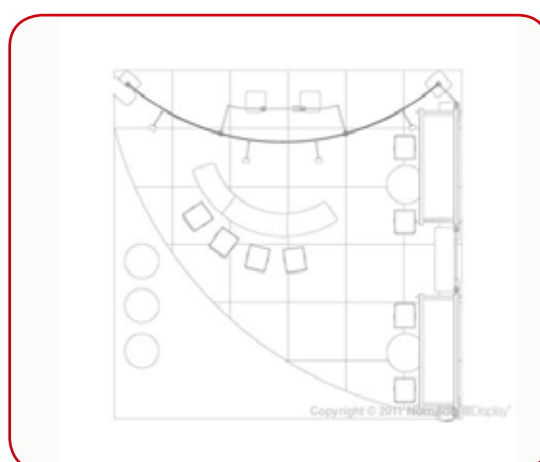



FEATURES

- Integrated A/W Workstation
- Walk-In Storage
- Open Seating Area
- Brochure Holder
- Overhead Messaging
- Sculpted Accent Fins

CASING

- 1 Large Plywood Case
- 150kgs packed weight per case
- 3 Flatpack 300 Cases
- 45kgs packed weight per case

PLAN VIEW

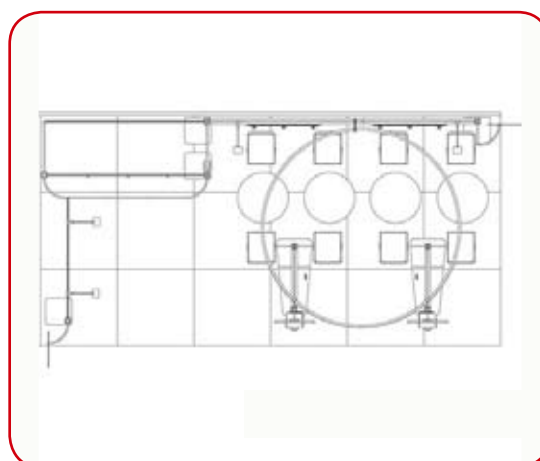



FEATURES

- Integrated A/W Workstation
- Walk-In Storage
- Open Seating Area
- Brochure Holder
- Overhead Messaging
- Free-standing Counter

CASING

- 2 Large Plywood Cases
- 150 kgs packed weight per case
- 5 Flatpack 300 Cases
- 45 kgs packed weight per case
- 2 Large Panel Cases
- 65 kgs packed weight per case

PLAN VIEW

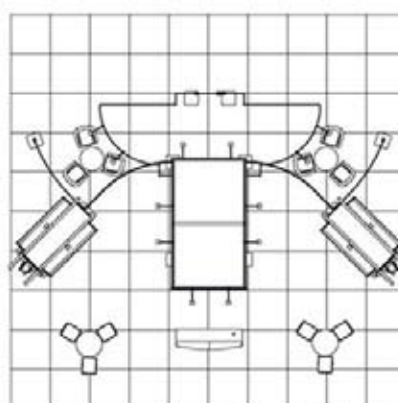

Copyright © 2011 Nomadic3D.com



FEATURES

- Integrated A/W Workstation
- Walk-In Storage
- Private Meeting Area
- Brochure Holder
- Overhead Messaging
- Free-standing Counter

CASING

- 1 Super Tub
- 650 kgs packed weight per case
- 1 Large Plywood Cases
- 150 kgs packed weight per case

PLAN VIEW

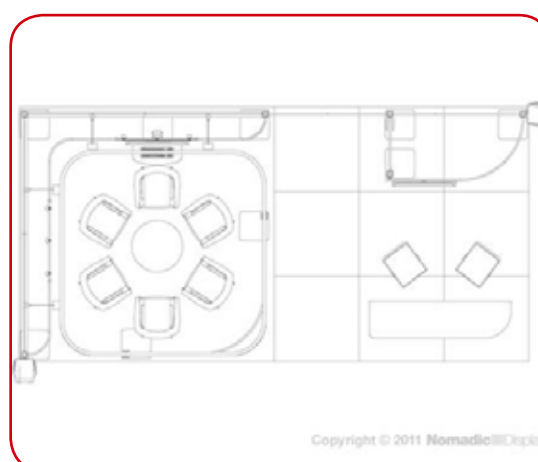



FEATURES

- Integrated A/W Workstation
- Walk-In Storage
- Semi-Private Meeting Area
- Brochure Holder
- Overhead Messaging
- Free-standing Counter

CASING

- 2 Large Plywood Packing Case
- 150 kgs packed weight per case
- 1 PanelCase - Large Rotomoulded
- 65 kgs packed weight per case

PLAN VIEW

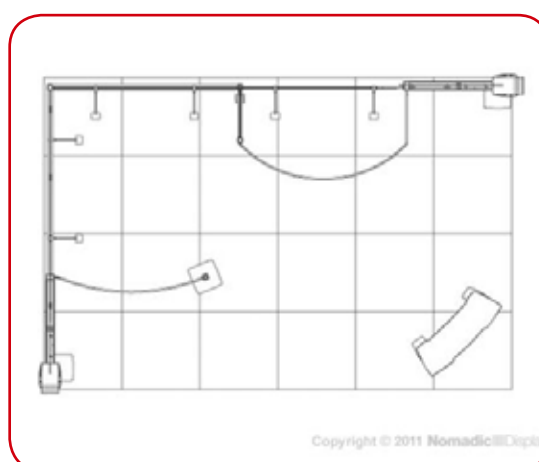



FEATURES

- Tension fabric Structure
- Tension Fabric Graphics
- Walk-In Storage
- Bar Counter
- Locking Storage
- Lighting Solutions

CASING

- 3 Large Plywood Packing Case
- 150 kgs packed weight per case

PLAN VIEW

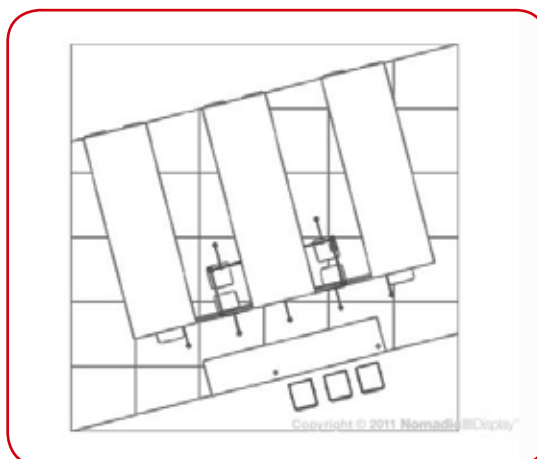



FEATURES

- Tension fabric Structure
- Tension Fabric Graphics
- Walk-In Storage
- Intergrated A/W Workstations
- Walk-In Storage
- Open Seating Area

CASING

- 5 FlatPack 300 Cases
- 2 PanelCases

PLAN VIEW

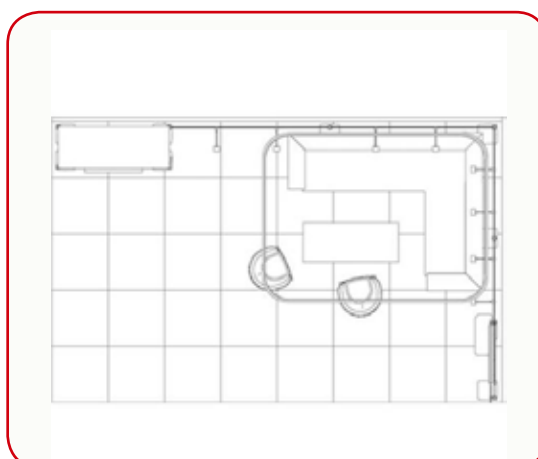



FEATURES

- Tension fabric Structure
- Tension Fabric Graphics
- Walk-In Storage
- Open Seating Area
- Overhead Messaging
- Brochure Holders

CASING

- 2 Plywood Cases, Large
- 1 Panel Case, Large

PLAN VIEW

